



JAMIE WARNER
— ESTATE AGENTS —



25 Dane Close, Kedington, Suffolk, CB9 7NX

Guide Price £320,000

- Three Bedrooms
- Conservatory
- Popular Village Location
- Sitting Room
- South Facing Garden
- Kitchen /Dining Room
- Views Over Open Fields

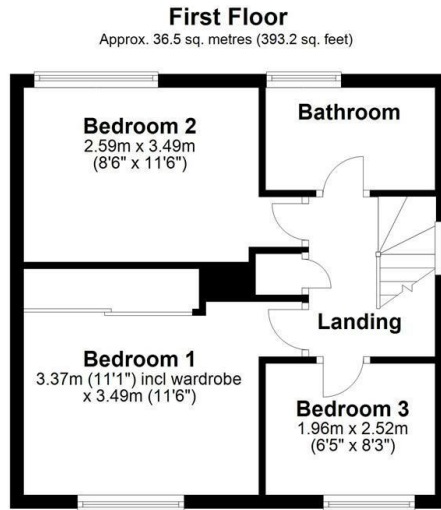
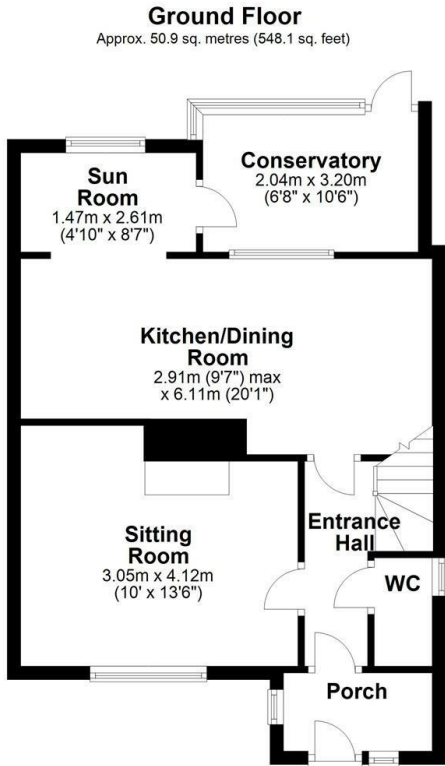

Total area: approx. 87.5 sq. metres (941.4 sq. feet)

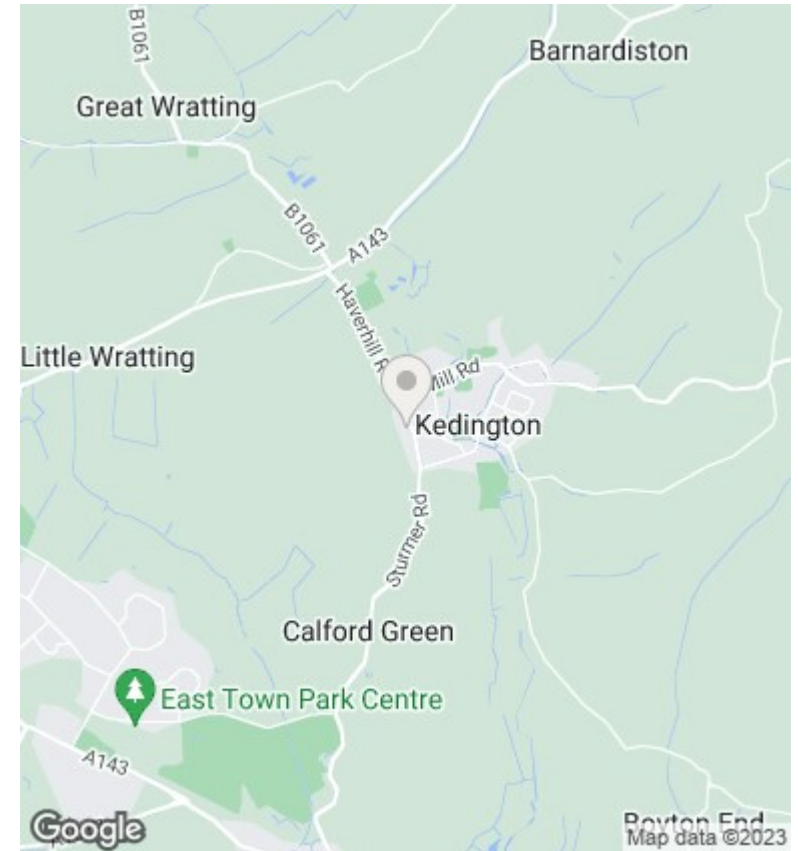

Directions

Viewings

Viewings by arrangement only. Call 01440 712221 to make an appointment.

Council Tax Band

B

EPC Rating:

D

Energy Efficiency Rating		
	Current	Potential
Very energy efficient - lower running costs		
(92 plus) A		
(81-91) B		82
(69-80) C		
(55-68) D	66	
(39-54) E		
(21-38) F		
(1-20) G		
Not energy efficient - higher running costs		
England & Wales	EU Directive 2002/91/EC	